

FT-800

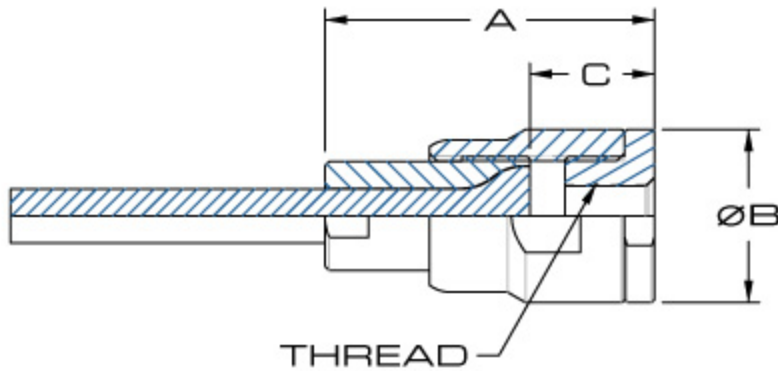

Female



STANDARD LENGTH						
P/N	SIZE	A	ØB	C	TRAVEL±	THREAD
R-X-FSX-0250-S	1/4"	2.454	0.938	0.813	0.375	5/16-24 UNF-2B
R-X-FSX-0312-S	5/16"	2.829	1.125	0.907	0.375	3/8-24 UNF-2B
R-X-FSX-0375-S	3/8"	3.064	1.375	1.064	0.375	1/2-20 UN-2B
R-X-FSX-0500-S	1/2"	3.655	1.750	1.251	0.375	5/8-18 UN-2B
R-X-FSX-0625-S	5/8"	4.019	2.000	1.439	0.375	3/4-16 UNF-2B
R-X-FSX-0750-S	3/4"	4.978	2.375	1.751	0.500	1-12 UN-2B
R-X-FSX-0875-S	7/8"	5.573	2.750	1.909	0.500	1-12 UNF-2B
R-X-FSX-1000-S	1"	5.832	3.000	2.002	0.500	1 1/4-12 UN-2B

EXTENDED LENGTH						
P/N	SIZE	A	ØB	C	TRAVEL±	THREAD
R-X-FEX-0250-S	1/4"	3.846	0.938	1.416	0.750	5/16-24 UNF-2B
R-X-FEX-0312-S	5/16"	4.174	1.125	1.448	0.750	3/8-24 UNF-2B
R-X-FEX-0375-S	3/8"	4.437	1.375	1.624	0.750	1/2-20 UN-2B
R-X-FEX-0500-S	1/2"	4.856	1.750	1.625	0.750	5/8-18 UN-2B
R-X-FEX-0625-S	5/8"	5.090	2.000	1.749	0.750	3/4-16 UNF-2B
R-X-FEX-0750-S	3/4"	6.402	2.375	2.062	1.000	1-12 UN-2B
R-X-FEX-0875-S	7/8"	7.048	2.750	2.239	1.000	1-12 UNF-2B
R-X-FEX-1000-S	1"	7.267	3.000	2.271	1.000	1 1/4-12 UN-2B



FRONTIER TECHNOLOGIES 
CUTTING EDGE MECHANICAL DESIGN